

TAPONES ROSCA MACHO CABEZA HEXAGONAL

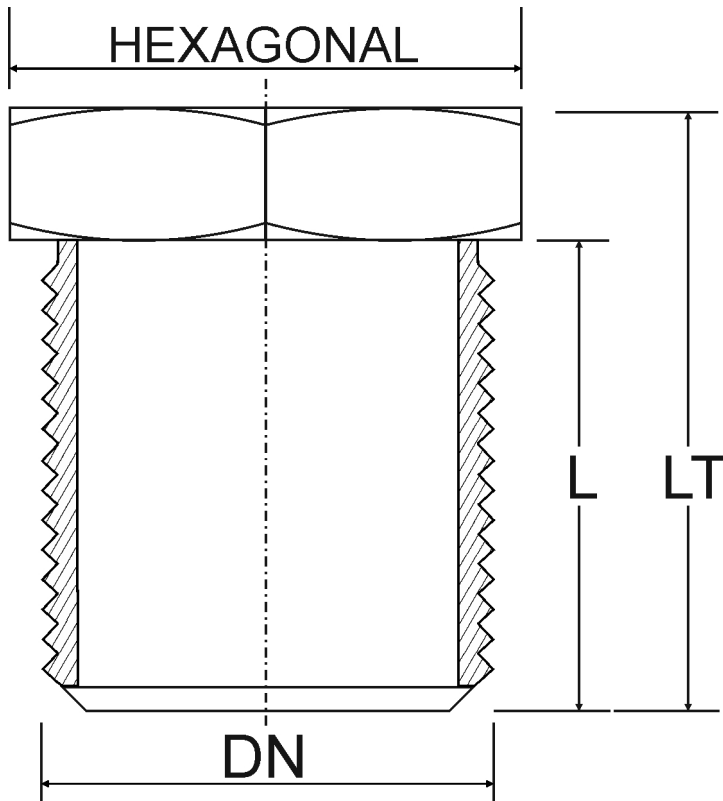

DN	HEXAGONAL	LT	L
1/2"	27 mm	35 mm	23 mm
3/4"	30 mm	37 mm	24 mm
1"	38 mm	38 mm	24 mm
1 1/4"	45 mm	40 mm	26 mm

- Material: Acero Carbono F212-UNE-EN 107277-3 2009 ó equivalente
- Rosca: BSP (UNE-EN ISO 228-1)